

**PART LAYOUT PLAN AT INDUSTRIAL AREA - BABBALA**  
 AMENDED DATE ON 20-08-2008 (ONLY FOR REFERENCE)

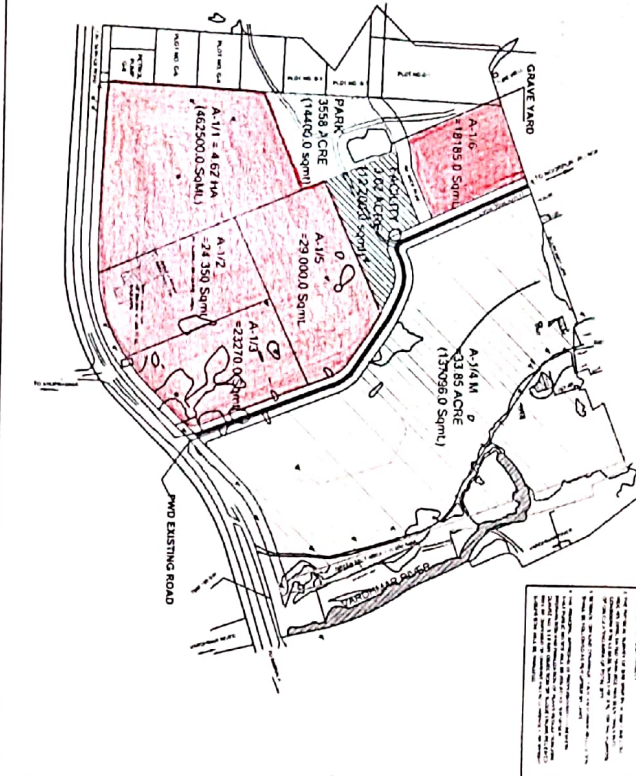

**NOTES**  
 1. The layout is prepared in accordance with the provisions of the Town and Country Planning Act, 1973 and the Town and Country Planning (Amendment) Act, 1988.  
 2. The layout is prepared on the basis of the information furnished by the applicant and the authorities concerned.  
 3. The layout is subject to the approval of the competent authority.  
 4. The layout is prepared on the basis of the information furnished by the applicant and the authorities concerned.  
 5. The layout is subject to the approval of the competent authority.

PROPOSED FOR APPROVAL				AS PER PREVIOUSLY APPROVED			
SN	USE	AREA IN HECTA	%	SN	USE	AREA IN HECTA	%
1	INDUSTRIAL	114.89	100	1	INDUSTRIAL	114.89	100
2	PARK	2.00	1.75	2	PARK	2.00	1.75
3	ROAD	1.20	1.05	3	ROAD	1.20	1.05
4	FACILITY	1.20	1.05	4	FACILITY	1.20	1.05
5	TOTAL	120.29	100	5	TOTAL	120.29	100

**INDEX**

**INDUSTRIAL AREA BABBALA, BADAUN**  
 AMENDED DATE ON 20-08-1991 (ONLY FOR REFERENCE)

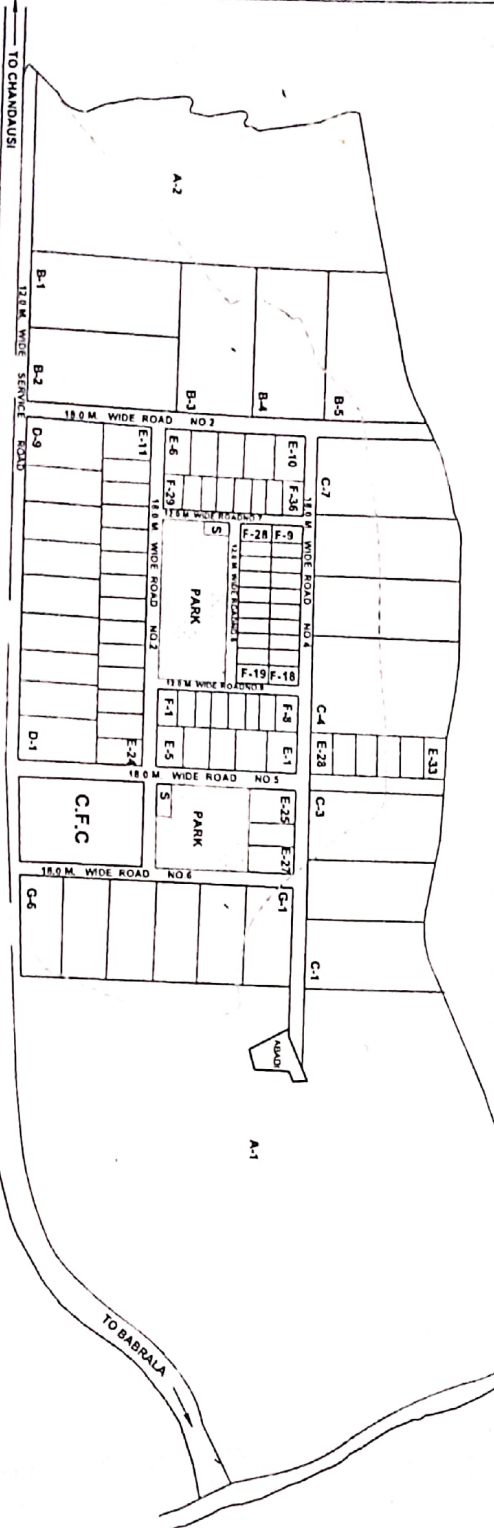

**DISCLAIMER.**  
 THIS MAP IS PROVIDED FOR INFORMATION PURPOSE ONLY AND IS NOT INTENDED FOR... THE INFORMATION PRESENTED HEREIN INCLUDING... THE MAP SHOULD NOT BE USED AS A MEASUREMENT OR LEGAL VALIDATION FOR RECORDING... BINDING INFORMATION PLEASE CONSULT RELEVANT OFFICE AUTHORITY.

**LAND USE ANALYSIS**

S.N.	USE	AREA IN HECTA	%
1	INDUSTRIAL PLOTS	76.85	47.50
2	PARK	1.05	3.47
3	ROAD	6.23	6.67
4	SHOPPING	3.13	0.95
5	C.F.C.	1.76	2.00
	<b>TOTAL</b>	<b>87.82</b>	<b>100.00</b>

**STATEMENT OF PLOTS**

S.N.	TYPE	SIZE	AREA IN SQ.MT.	NOS.
1	A-1	TO SIZE	271500.00	24
2	A-2	TO SIZE	68450.00	01
3	A-3	TO SIZE	130420.00	01
4	A-4	TO SIZE	290000.00	05
5	A-5	TO SIZE	19000.00	01
6	A-6	TO SIZE	518100.00	04
7	A-7	TO SIZE	12000.00	01
8	A-8	TO SIZE	20440.00	01
9	A-9	TO SIZE	80100.00	01
10	A-10	TO SIZE	20440.00	01
11	A-11	TO SIZE	20440.00	01
12	A-12	TO SIZE	20440.00	01
13	A-13	TO SIZE	20440.00	01
14	A-14	TO SIZE	20440.00	01
15	A-15	TO SIZE	20440.00	01
16	A-16	TO SIZE	20440.00	01
17	A-17	TO SIZE	20440.00	01
18	A-18	TO SIZE	20440.00	01
19	A-19	TO SIZE	20440.00	01
20	A-20	TO SIZE	20440.00	01
21	A-21	TO SIZE	20440.00	01
22	A-22	TO SIZE	20440.00	01
23	A-23	TO SIZE	20440.00	01
24	A-24	TO SIZE	20440.00	01
25	A-25	TO SIZE	20440.00	01
26	A-26	TO SIZE	20440.00	01
27	A-27	TO SIZE	20440.00	01
28	A-28	TO SIZE	20440.00	01
29	A-29	TO SIZE	20440.00	01
30	A-30	TO SIZE	20440.00	01
31	A-31	TO SIZE	20440.00	01
32	A-32	TO SIZE	20440.00	01
33	A-33	TO SIZE	20440.00	01
34	A-34	TO SIZE	20440.00	01
35	A-35	TO SIZE	20440.00	01
36	A-36	TO SIZE	20440.00	01
37	A-37	TO SIZE	20440.00	01
38	A-38	TO SIZE	20440.00	01
39	A-39	TO SIZE	20440.00	01
40	A-40	TO SIZE	20440.00	01
41	A-41	TO SIZE	20440.00	01
42	A-42	TO SIZE	20440.00	01
43	A-43	TO SIZE	20440.00	01
44	A-44	TO SIZE	20440.00	01
45	A-45	TO SIZE	20440.00	01
46	A-46	TO SIZE	20440.00	01
47	A-47	TO SIZE	20440.00	01
48	A-48	TO SIZE	20440.00	01
49	A-49	TO SIZE	20440.00	01
50	A-50	TO SIZE	20440.00	01

AREA OF I PHASE = 43.34 HECTA = 107.06 ACRES  
 AREA OF II PHASE = 44.48 HECTA = 109.88 ACRES

ARCHITECTURAL CELL

**PSIDA**  
 ARCHITECTURAL CELL  
 UPSIDA COMPLEX  
 A-1/4 LAKHANPUR KANPUR PIN 208024

**JOB TITLE:-**  
 INDUSTRIAL AREA BABBALA DISTT BADAUN

**SD**  
 R.K. SRIVASTAVA  
 DY MANAGER (ARCH)

**SD**  
 BHUPESH SINGH  
 MANAGER (T.P.)

**DRG. TITLE:-**  
 LAYOUT PLAN

**SD**  
 CH. A. T. P. D. Y. G. M. (IM)

**SD**  
 S.N. SHUKLA  
 GENERAL MANAGER

**SD**  
 H.S. NARAYAN  
 MANAGING DIRECTOR

**REVISION NO**

**SCALE - 1:4000**

**DATE - 20-08-91**

**DRG. NO**

**DEALT BY - U.S. YADAV**