

LAYOUT PLAN OF INDUSTRIAL ESTATE BHETUA DISTT. SULTANPUR
AMENDED DATE ON 22-03-2001 (ONLY FOR REFERENCE)

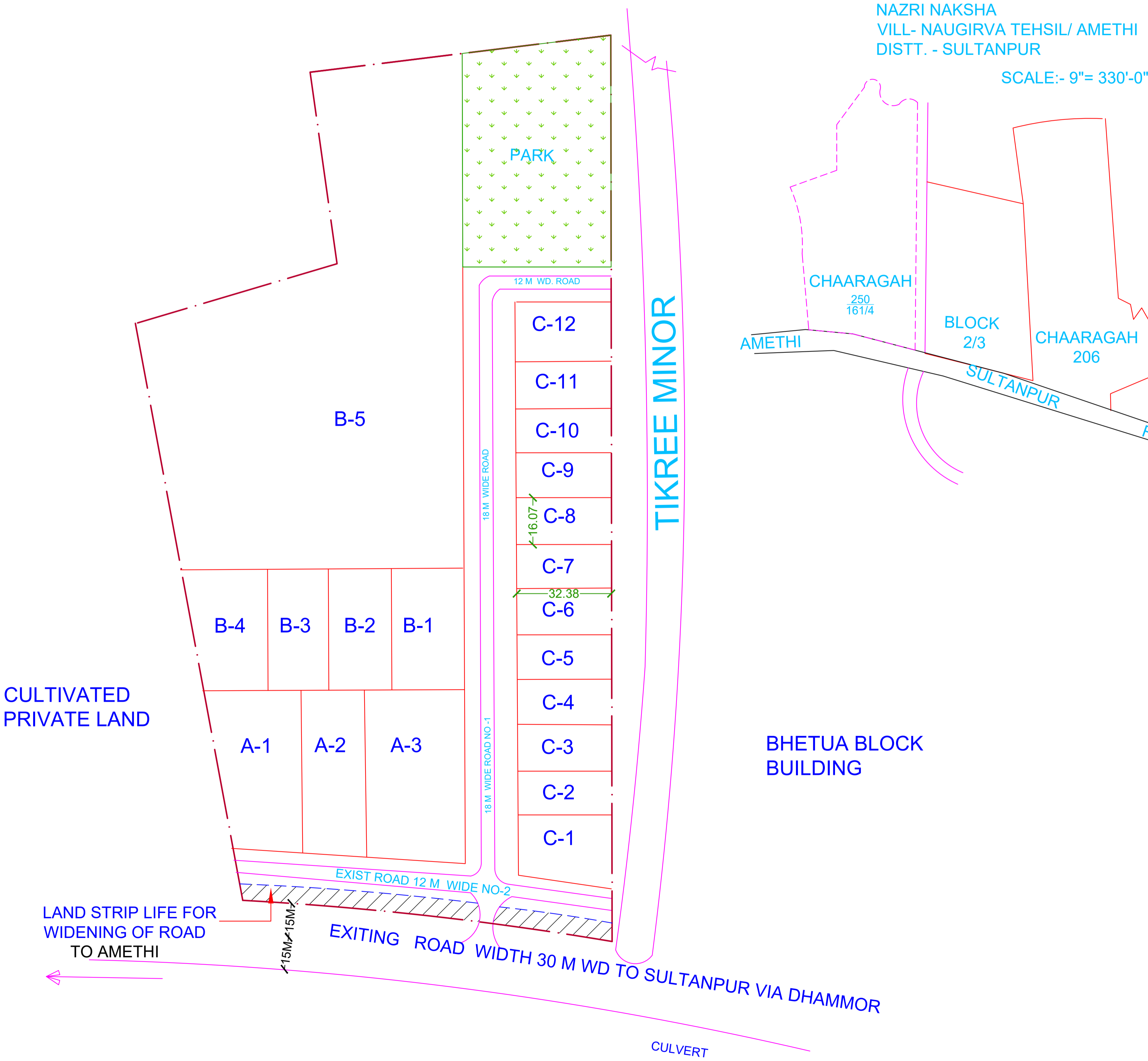

NAZRI NAKSHA
 VILL- NAUGIRVA TEHSIL/ AMETHI
 DISTT. - SULTANPUR
 SCALE:- 9"= 330'-0"

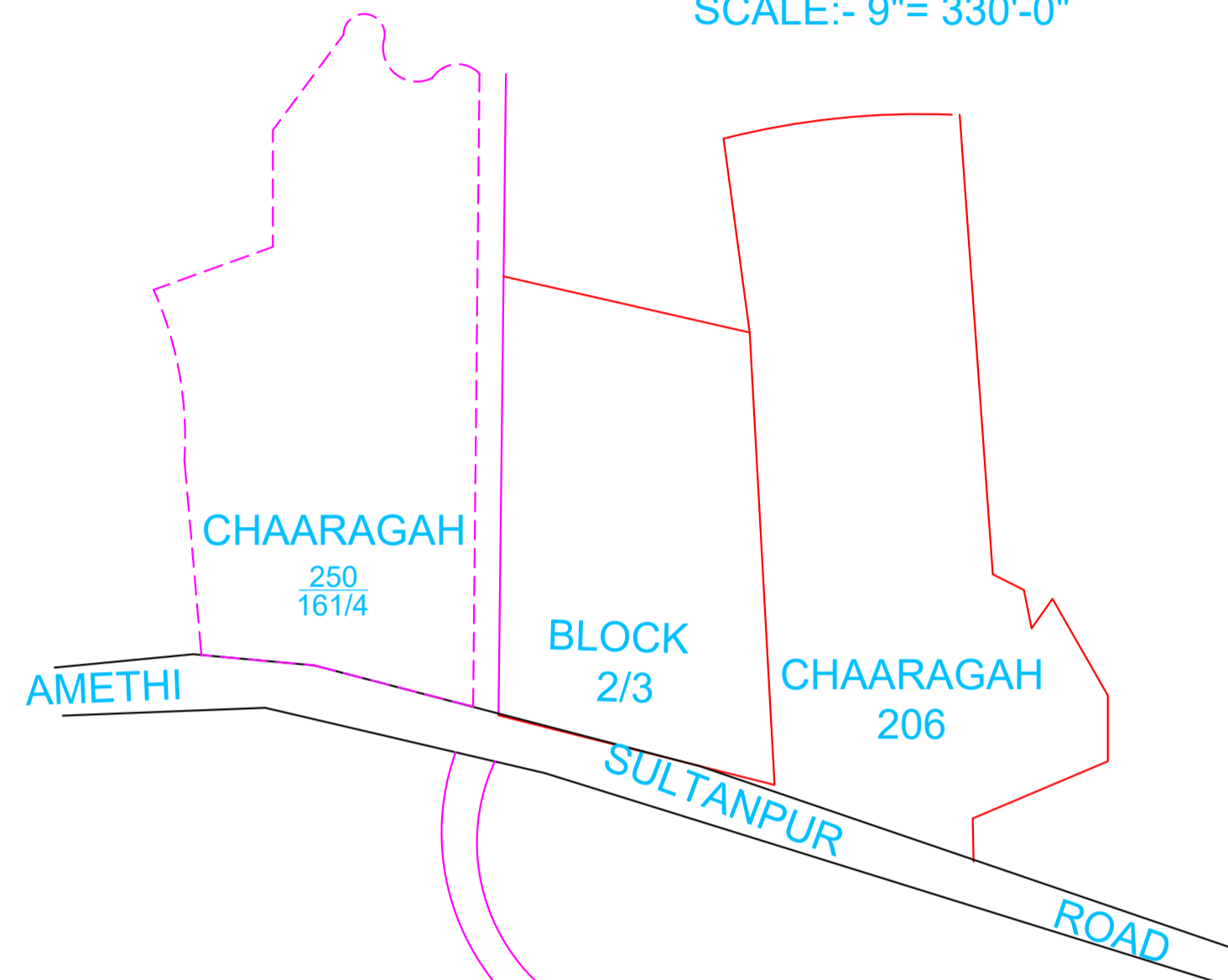

DISCLAIMER:-

THIS MAP IS PROVIDED FOR INFORMATION PURPOSE ONLY AND IS NOT INTENDED FOR USE IN LEGAL PROCEEDINGS. THE ACCURACY AND COMPLETENESS OF THE INFORMATION REPRESENTED ARE NOT GUARANTEED. THE INFORMATION PRESENTED HEREIN, INCLUDING BOUNDARIES, LAND USE DESIGNATIONS, AND OTHER DETAILS, IS SUBJECT TO CHANGE WITHOUT PRIOR NOTICE. THE MAP SHOULD NOT BE USED AS A LEGAL DOCUMENT OR FOR ANY PURPOSE REQUIRING PRECISE MEASUREMENTS OR LEGAL VALIDATION. FOR OFFICIAL AND LEGALLY BINDING INFORMATION PLEASE CONSULT RELEVANT OFFICE AUTHORITY.

LAND USE ANALYSIS :-

SNO.	USE	AREA IN HECT	SNO.
1.	PLOTS	2.62	74.22
2.	PARK	0.36	10.20
3.	ROADS	0.31+0.24 (EXIST+PROS)	15.58
TOTAL		3.53	100.00

STATEMENT OF PLOTS:-

SNO.	TYPE	SIZE IN MTS	AREA IN SQM	NOS
1.	A	20 X 50	1000	3
2.	B-1 TO B-4	20 X 40	800	4
3.	B-5	TO SIZE	12518.00	1
4.	C	15 X 30	450	12
TOTAL				19

BOUNDARY LINE

ARCHITECTURAL CELL



UPSIDA COMPLEX
 A 1/4 LAKHANPUR KANPUR.

JOB TITLE: LAYOUT PLAN INDUSTRIAL ESTATE BHETUA DISTT.- SULTANPUR	SD. KANCHAN HANSPAL ASSTT. MANAGER(ARCH)
	SD. AIJAZ HUSSAI DY MANAGER(ARCH)
	SD. BHUPESH SINGH SR MANAGER(A.T.P)
	SD. Y.P SINGH GENERAL MANAGER(DEV)
	SD. ARUN SINGHAL JT MANAGING DIRECTOR
REVISION NO-1	SD. RAJIVE KUMAR MANAGING DIRECTOR
SCALE-1CM=10M	DATE :- 22-03-2001
DRG NO.	

DEAT:- SANGEETA PANDEY