

LAYOUT PLAN OF INDUSTRIAL TOWN SHIP (INDUSTRIAL & RESIDENTIAL) AMETHI (KAUHAR)

AMENDED DATE ON 03-11-2016 (ONLY FOR REFERENCE)

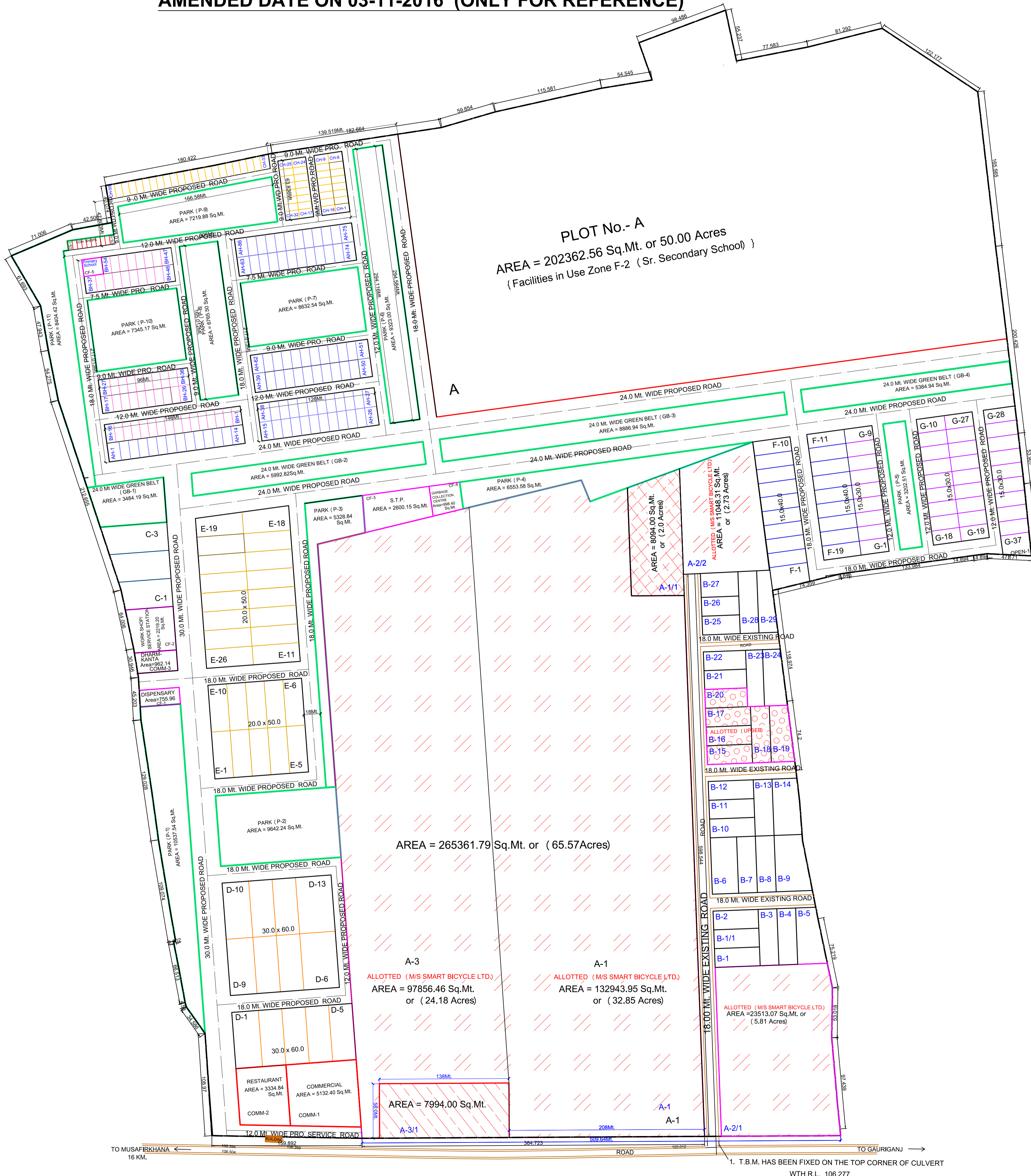

LAND USE ANALYSIS - RESIDENTIAL AREA (PROPOSED)			DESCRIPTION OF AREA					
SL. NO.	USE	AREA IN Sq.Mt.	% OF TOTAL	SL. NO.	USE	TOTAL AREA IN Sq.Mt.	AREA IN ACRES	% OF TOTAL
1	PHASE-I	33984.34	16.70	1	EXISTING INDUSTRIAL AREA (PHASE-I)	44920.00	11.44	16.49
2	RESIDENTIAL (PROPOSED)	33984.34	16.70	2	NET EXISTING INDUSTRIAL AREA	33120.00	8.44	15.84
3	COMMERCIAL	500.00	0.24	3	PROPOSED INDUSTRIAL AREA (PHASE-II)	42000.00	10.79	16.23
4	INFRASTRUCTURE	202362.56	100.00	4	INDUSTRIAL (PROPOSED)	33120.00	8.44	15.84
5	PARK (GREEN BELT)	202362.56	100.00	5	NET AREA (PHASE-I)	11800.00	3.03	17.31
6	ROADS	47000.00	23.22					
7	TOTAL	202362.56	100.00					
8	GRAND TOTAL	317746.55	100.00					

RESIDENTIAL PLOTS (PROPOSED)			LAND USE ANALYSIS - INDUSTRIAL AREA (EXISTING & PROPOSED)									
SL. NO.	TYPE	SIZE IN MT.	AREA IN Sq.Mt.	BLOCK AREA	PLT. NO.	UNITS	REMARK	SL. NO.	USE	AREA IN Sq.Mt.	AREA IN ACRES	% OF TOTAL
1	AH-1 TO AH-6	200.00	18000.00	86	3	810	HOUSING	1	INDUSTRIAL (EXISTING)	30849.79	52.35	16.49
2	BH-1 TO BH-54	182.00	23200.00	54	3	810	HOUSING	2	INDUSTRIAL (PROPOSED)	42000.00	107.90	16.23
3	CH-1 TO CH-55	132.00	13200.00	55	2	2450	HOUSING	3	INDUSTRIAL (PROPOSED)	33120.00	84.30	15.84
4	TOTAL		54400.00	195		2460		4	INDUSTRIAL (PROPOSED)	33120.00	84.30	15.84

PARK / GREEN BELT (IN PROPOSED RESIDENTIAL AREA)			AS PER UPSIDA		
SL. NO.	TYPE	AREA IN ACRES	REQUIRED	PROPOSED	REMARK
1	PARK	2.80	2.80	2.80	2.80
2	PARK	2.33	2.33	2.33	2.33
3	PARK	1.87	1.87	1.87	1.87
4	PARK	1.78	1.78	1.78	1.78
5	PARK	1.81	1.81	1.81	1.81
6	PARK	1.08	1.08	1.08	1.08
7	TOTAL	13.78	13.78	13.78	13.78

REQUIRED PARK AREA AS PER UPSIDA NORMS (RESIDENTIAL)			POPULATION			
SL. NO.	USE	AREA IN Sq.Mt.	REMARK	SL. NO.	USE	POPULATION
1	INDUSTRIAL (EXISTING)	44920.00	1500	1	INDUSTRIAL (EXISTING)	442
2	INDUSTRIAL (PROPOSED)	42000.00	4150	2	INDUSTRIAL (PROPOSED)	4018
3	TOTAL	86920.00	8692	3	TOTAL	8420
4	FLORISSING POPULATION @ 20% OF GROSS POPULATION	17384.00	17384	4	FLORISSING POPULATION @ 20% OF GROSS POPULATION	17384
5	REQUIRED PARK/GREEN BELT @ 0.3 HECT/1000 PERSON	5215.20	5215.20	5	REQUIRED PARK/GREEN BELT @ 0.3 HECT/1000 PERSON	5215.20
6	PROPOSED PARK/GREEN BELT	13.78	13.78	6	PROPOSED PARK/GREEN BELT	13.78
7	REMARK			7	REMARK	

STATEMENT OF PLOTS - EXISTING INDUSTRIAL AREA (PHASE-I)			STATEMENT OF PLOTS - INDUSTRIAL AREA (PHASE-II)		
SL. NO.	TYPE	SIZE IN MT.	TOTAL PLOT AREA	IN Sq.Mt.	REMARK
1	INDUSTRIAL PLOTS (EXISTING)				
2	A-2/1	TO SIZE	132943.95	132943.95	1
3	A-2/2	TO SIZE	23513.07	23513.07	1
4	A-2/3	TO SIZE	11086.81	11086.81	1
5	A-2/4	TO SIZE	97856.46	97856.46	1
6	A-2/5	TO SIZE	8094.00	8094.00	1
7	TOTAL	TO SIZE	265361.79	265361.79	4
8	INDUSTRIAL AREA	TO SIZE	4046.85	4046.85	1
9	A-1/1	TO SIZE	23513.07	23513.07	1
10	A-1/2	TO SIZE	7994.00	7994.00	1
11	TOTAL	TO SIZE	18300.00	18300.00	2
12	TOTAL (SL. NO. 5-8)		281449.79	281449.79	6
13	B-1	TO SIZE	4046.85	4046.85	1
14	B-2	TO SIZE	4046.85	4046.85	1
15	B-3	TO SIZE	4046.85	4046.85	1
16	B-4	TO SIZE	4046.85	4046.85	1
17	B-5	TO SIZE	4046.85	4046.85	1
18	B-6	TO SIZE	4046.85	4046.85	1
19	B-7	TO SIZE	4046.85	4046.85	1
20	B-8	TO SIZE	4046.85	4046.85	1
21	B-9	TO SIZE	4046.85	4046.85	1
22	B-10	TO SIZE	4046.85	4046.85	1
23	B-11	TO SIZE	4046.85	4046.85	1
24	B-12	TO SIZE	4046.85	4046.85	1
25	B-13	TO SIZE	4046.85	4046.85	1
26	B-14	TO SIZE	4046.85	4046.85	1
27	B-15	TO SIZE	4046.85	4046.85	1
28	B-16	TO SIZE	4046.85	4046.85	1
29	B-17	TO SIZE	4046.85	4046.85	1
30	B-18	TO SIZE	4046.85	4046.85	1
31	B-19	TO SIZE	4046.85	4046.85	1
32	TOTAL	TO SIZE	11800.00	11800.00	15
33	TOTAL (SL. NO. 9-32)		281449.79	281449.79	2
34	C-1	TO SIZE	3334.00	3334.00	1
35	C-2	TO SIZE	3334.00	3334.00	1
36	C-3	TO SIZE	3334.00	3334.00	1
37	TOTAL	TO SIZE	10000.00	10000.00	3
38	TOTAL (SL. NO. 33-37)		281449.79	281449.79	5
39	TOTAL (INDUSTRIAL)		281449.79	281449.79	10
40	INDUSTRIAL AREA (AS PER W.F. FOR INDUSTRIAL PLOTS)		308	308	1
41	INDUSTRIAL AREA (GROSS POPULATION FOR INDUSTRIAL PLOTS)		4150	4150	1
42	TOTAL		4458	4458	2

NOTE:-

- REVISION NO. - 4 LAYOUT PLAN IS PREPARED AS PER DISCUSSION OF OF Sr. MANAGER (PROJ.) / UPSIDA.
- PLOT No. A-1/1, A-3/1 INCROACHED BY SMART BICYCLE & PLOT No. B-14, B-25, B-26 ARE CANCELLED AS PER LIST OF PLOTS PROVIDED BY R.M. FAIZABAD.
- SURVEY PLAN PROVIDED BY Ex. Eng. CD. - 7. VIDE LETTER No. 54 Dt. 28-09-2015.
- EXISTING INDUSTRIAL AREA PHASE-I SHOWN AS
- PROPOSED INDUSTRIAL AREA PHASE-II SHOWN AS
- PROPOSED HOUSING AREA PHASE-I SHOWN AS
- AREA ALLOTTED TO M/S SMART BICYCLE SHOWN AS
- AREA ENCROCHED BY M/S SMART BICYCLE SHOWN AS
- AREA ALLOTTED TO UPSEB SHOWN AS
- SETBACK SHOULD BE FOLLOWED AS PER UPSIDA BYE-LAWS.

DISCLAIMER:-

THIS MAP IS PROVIDED FOR INFORMATION PURPOSE ONLY AND IS NOT INTENDED FOR USE IN LEGAL PROCEEDINGS. THE ACCURACY AND COMPLETENESS OF THE INFORMATION REPRESENTED ARE NOT GUARANTEED. THE INFORMATION PRESENTED HEREIN, INCLUDING BOUNDARIES, LAND USE DESIGNATIONS, AND OTHER DETAILS, IS SUBJECT TO CHANGE WITHOUT PRIOR NOTICE. THE MAP SHOULD NOT BE USED AS A LEGAL DOCUMENT OR FOR ANY PURPOSE REQUIRING PRECISE MEASUREMENTS OR LEGAL VALIDATION. FOR OFFICIAL AND LEGALLY BINDING INFORMATION PLEASE CONSULT RELEVANT OFFICE AUTHORITY.

ARCHITECTURAL CELL

UPSIDA

UPSIDA COMPLEX
A 1/4 LAKHANPUR KANPUR.

JOB TITLE:
LAYOUT PLAN OF " INDUSTRIAL TOWN - SHIP (Industrial & Residential) AMETHI (KAUHAR) DISTT.- AMETHI (U.P.)

ANJLI SRIVASTAVA
I/C Asstt. Manager (A.T.P.)

S.K. DIXIT
INCHARGE (A.T.P.)

REVISION NO. - 4

MANOJ SINGH
MANAGING DIRECTOR

Scale :1:3000
DATE : 03-11-2016
Drg. No. : upsidc/atp/

DEALT BY:- AMIT SRIVASTAVA (D/Man)

REVISION NO.-1 (Existing Layout Plan Approved on Dt. 28-10-1986)
REVISION NO.-2 (Approved on Dt. - 18-03-2016)
REVISION NO.-3 (Approved on Dt. - 03-06-2016)

1. T.B.M. HAS BEEN FIXED ON THE TOP CORNER OF CULVERT WITH R.L. 106.277