

LAYOUT PLAN OF INDUSTRIAL AREA BAREILLY PERSAKHERA

AMENDED DATE ON 19/02/88 (ONLY FOR REFERENCE)

DISCLAIMER:-
THIS MAP IS PROVIDED FOR INFORMATION PURPOSE ONLY AND IS NOT INTENDED FOR USE IN LEGAL PROCEEDINGS. THE ACCURACY AND COMPLETENESS OF THE INFORMATION REPRESENTED ARE NOT GUARANTEED. THE INFORMATION PRESENTED HEREIN, INCLUDING BOUNDARIES, LAND USE DESIGNATIONS, AND OTHER DETAILS, IS SUBJECT TO CHANGE WITHOUT PRIOR NOTICE. THE MAP SHOULD NOT BE USED AS A LEGAL DOCUMENT OR FOR ANY PURPOSE REQUIRING PRECISE MEASUREMENTS OR LEGAL VALIDATION. FOR OFFICIAL AND LEGALLY BINDING INFORMATION PLEASE CONSULT RELEVANT OFFICE AUTHORITY.

S.NO.	LAND USE	AREA IN ACRES
1.	AREA UNDER PLOTS	267.60
2.	AREA IN ROADS	68.96
3.	AREA IN PARKS	19.66
TOTAL		356.22

NOTE:-
THE SUB DIVISION OF PLOT NOS. A-12, A-14, B-28, B-67 TOB-69, D-33 TO D-44 AND E-19 TO E-53 HAS BEEN DONE IN COMPLIANCE OF C.P.E INSPECTION NOTE NO. 118/M.D. SIDE/ DATE 27-9-85 & ALSO DISCUSSION WITH HIM DATED ON 1.10.85

DETAILS OF PLOT

SI.NO.	TYPE	APPROX - SIZE	NOS.	AREA IN ACERS.
1.	A	300'X 625'		
2.	B	200'X300' TO 600'		
3.	C	150'X190'		
4.	D	100'X200'		
5.	E	75'X150'		
6.	F	50' X150'		

TOTAL				
SI.NO.	TYPE	APPROX - AREA	NOS.	AREA IN ACERS.
1.	S	600- 800 SQ. M.		
2.	S1	650 TO 1050 SQ.M.		
3.	S2	1100 - 1200 SQ.M.		
4.	S3	2000 - 2500 SQ.M.		
5.	S4	2500 - 3000 SQ.M.		
6.	S5	3501 - 4000 SQ. M.		
7.	S6	4001- 5000 SQ. M.		
TOTAL -				

SUB DIV. OF PLOT. NOS. A-6 , B-21 TO B- 25				
SI.NO.	TYPE	SIZE	AREA IN SQ. M.	NOS.
1.	M - 1	TO SIZE	10,000	01
2.	N-1 TO N-3	TO SIZE	1773 TO 2900	03
3.	P-1	TO SIZE	2400	01
4.	P-2 TO P- 8	30 X 60	1800	07
5.	P-9	35 X 60	2100	01
6.	R-1 TO R-10	TO SIZE	975 TO 1900	10
7.	T-1 TO T-19	15X30	450.00	19
TOTAL				

SUB DIV. OF PLOT. NOS. C-11, C-19 TO C-22				
SI.NO.	TYPE	SIZE	AREA IN SQ. M.	NOS.
8.	G-1 TO G-4	TO SIZE	2455 TO 4240	04
9.	H-1 TO H-7	TO SIZE	1800	07
10.	H-8	TO SIZE	3150	01
11.	H-9 TO H-11	TO SIZE	1740	03
12.	I-1 TO I-8	20X45	900	08
13.	J-1 TO J-9	20X40	800	09
TOTAL				

SUB DIV. OF PLOT. NOS. A-9 TO A-11				
SI.NO.	TYPE	SIZE	AREA IN SQ. M.	NOS.
14.	K-1	TO SIZE	8850.00	01
15.	K-2, K-3	40X140	5600.00	02
16.	K-4	50X140	7000.00	01
17.	K-5	TO SIZE	7840.00	01
18.	K-6	TO SIZE	3600.00	01
19.	L	20X40	800.00	14
TOTAL				

AMALGAMATED PLOT SHOWN AS 

ARCHITECTURAL CELL



UPSIDA COMPLEX
A-1/4, LAKHANPUR, KANPUR

JOB TITLE - LAYOUT PLAN OF INDUSTRIAL AREA PERSAKHERA BAREILLY	R. K. SRIVASTAVA DY. MANAGER (ARCH)
	SAT PERKASH DY. GENERAL MANAGER (I.M.)
	DY. HARI KRISHNA GENERAL MANAGER
	R.N. TRIVEDI MANAGING DIRECTOR

SCALE - CM =40M. DATE - 19-02-88
DRG.NO. SIDC/DY. GM. (I.M.)/

DELT BY - S.D. TRIPATHI D/MAN.

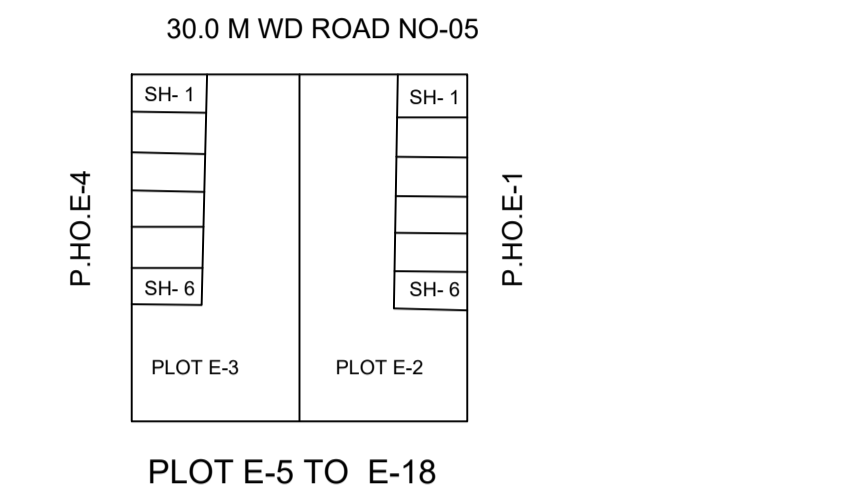

SUB DIVISION OF P.NO. E-2, E-3 SHOPS SIZE 5X10 MT. EACH.

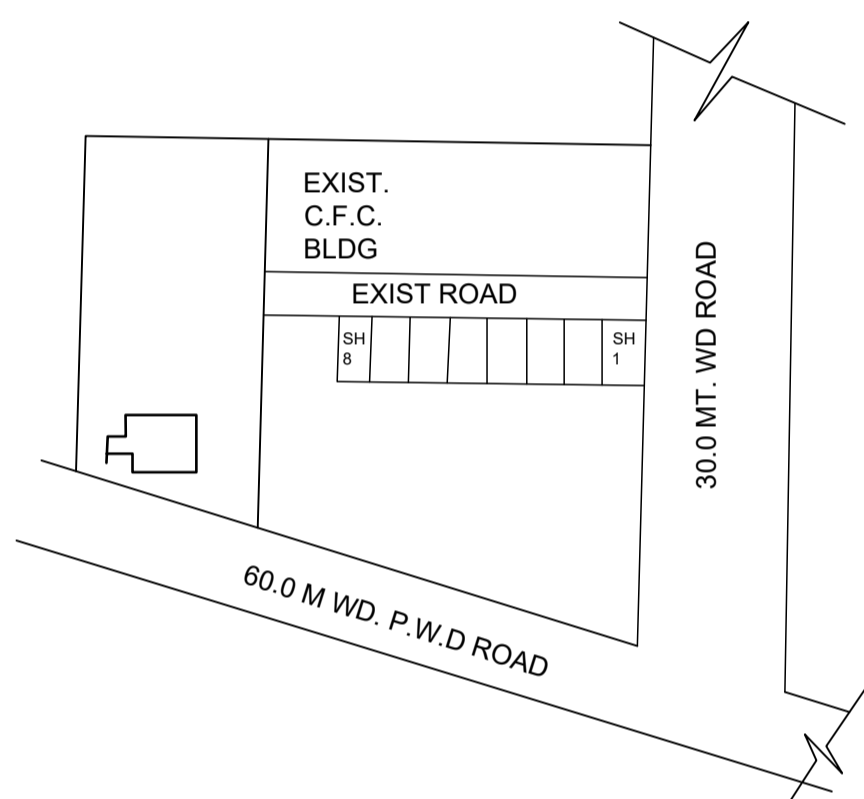

SUB DIVISION OF P.H.O. B-29 SHOP SIZE 5X10 MT. EACH

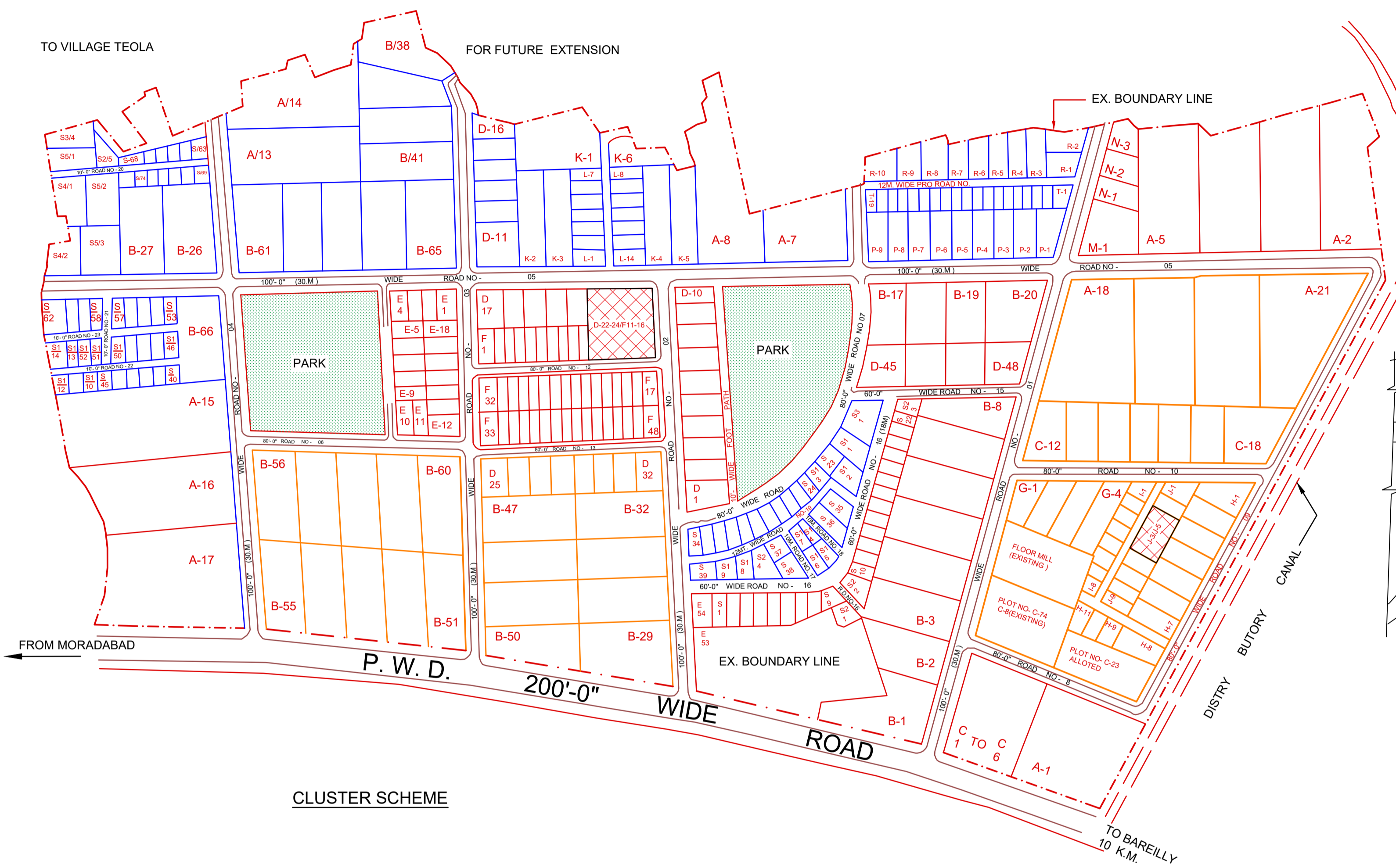

CLUSTER SCHEME

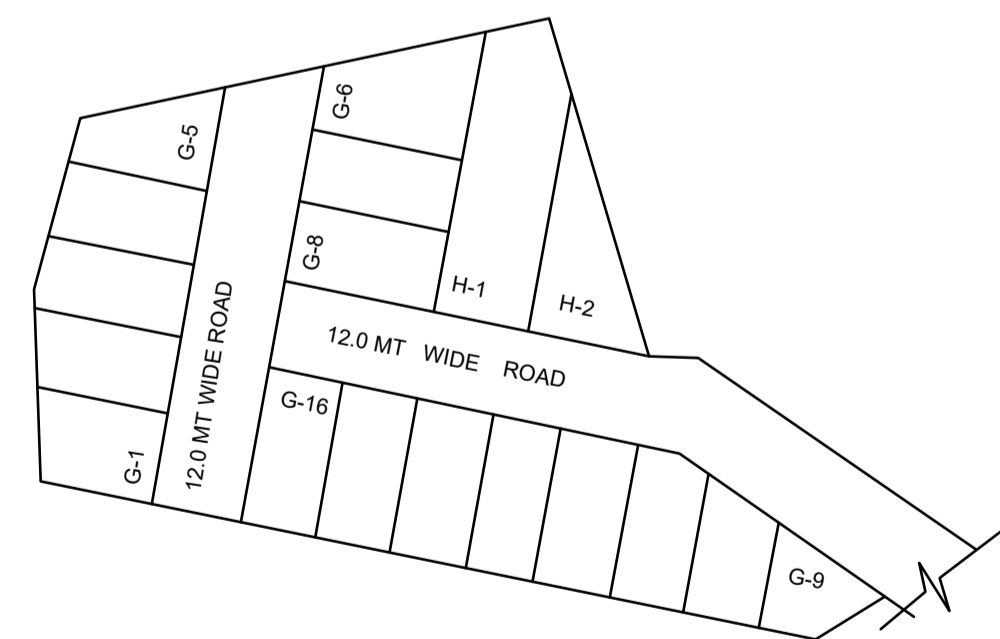

PLOT NO B/38

STATEMENT OF PLOTS

S.NO.	TYPE	SIZE IN MT.	AREA IN SQ.MT.	NO.
1.	G	10.0X20.0	200.00 SQ. M.	16
2.	H	TO SIZE	240.00 SQ. MT	02
TOTAL				
18				
JOB TITLE		R.K. SRIVASTAVA DY. MANAGER (ARCH)		
CLUSTER DEVELOPMENT OF PLOT #B/38 OF INDUSTRIAL AREA BAREILLY		BHUPESH SINGH SR. MANAGER (A.T.P)		
DRG TITLE - SUB DIVISION PLAN		Y.P. SINGH GENERAL MANAGER		
		ARUN SINGHAL JT. MANAGING DIRECTOR		
REVISION NO.		RAJIVE KUMAR MANAGING DIRECTOR		
		DATE - 20.09.99		
DELT BY- N.K. GAUTAM		D/ MAN		

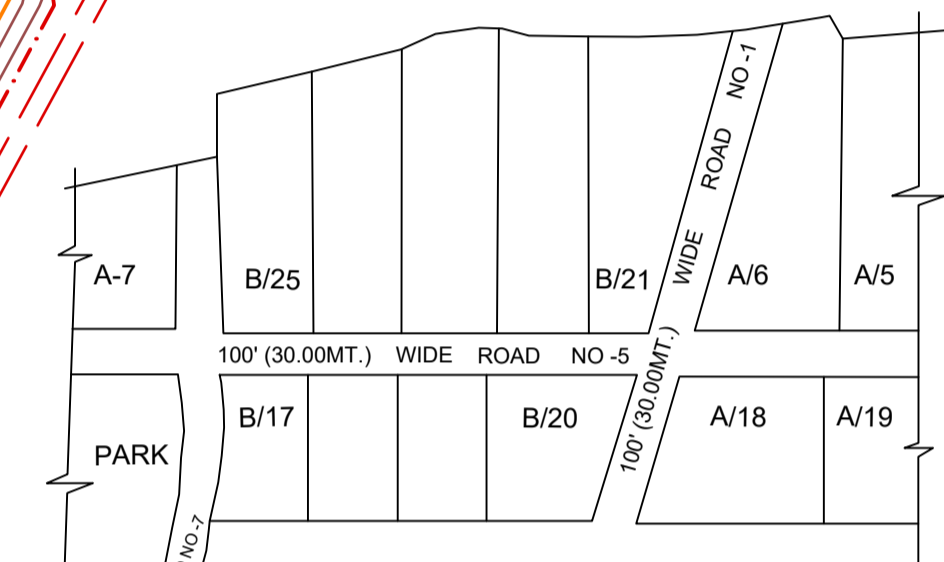

KEY PLAN (NOT TO SCALE)

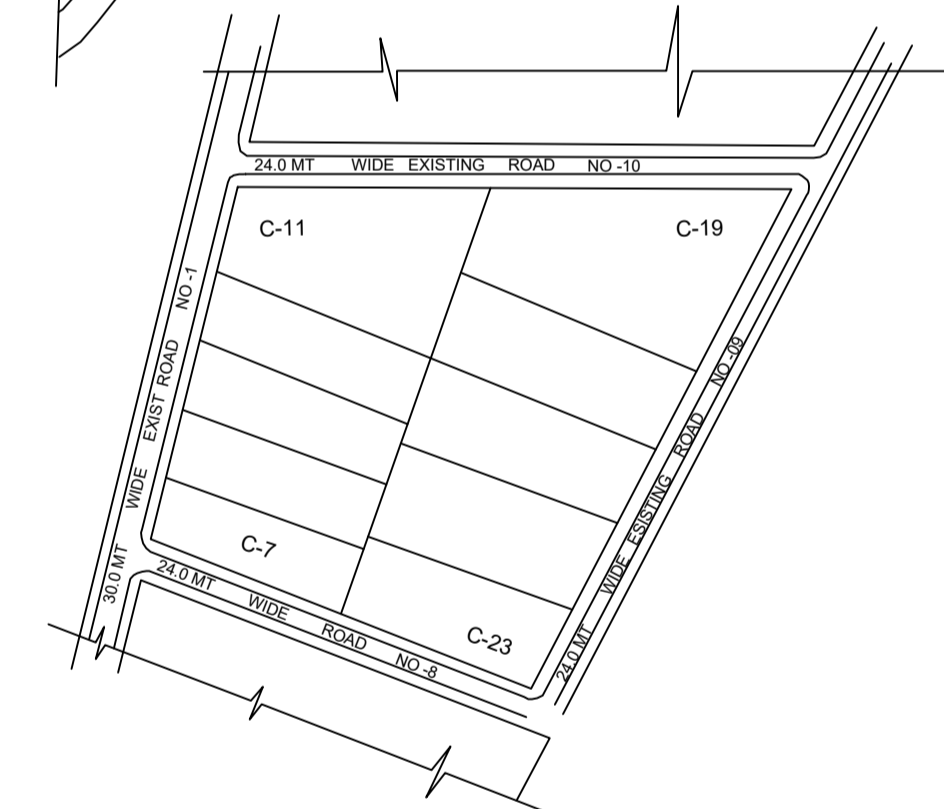

KEY PLAN (NOT TO SCALE)

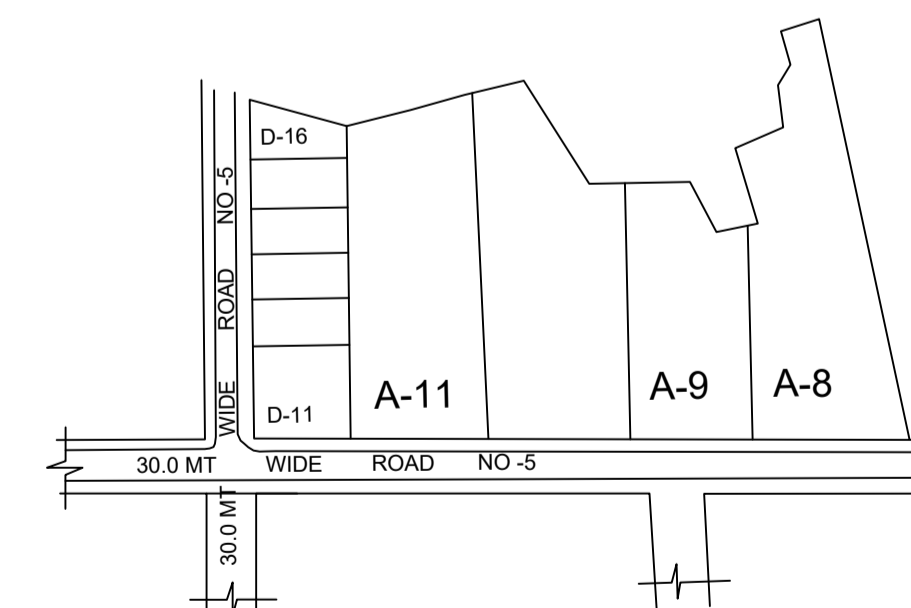

KEY PLAN (NOT TO SCALE)