

# LAYOUT PLAN OF INDUSTRIAL AREA GORAKHPUR

## AMENDED DATE ON 10/01/2019 (ONLY FOR REFERENCE)

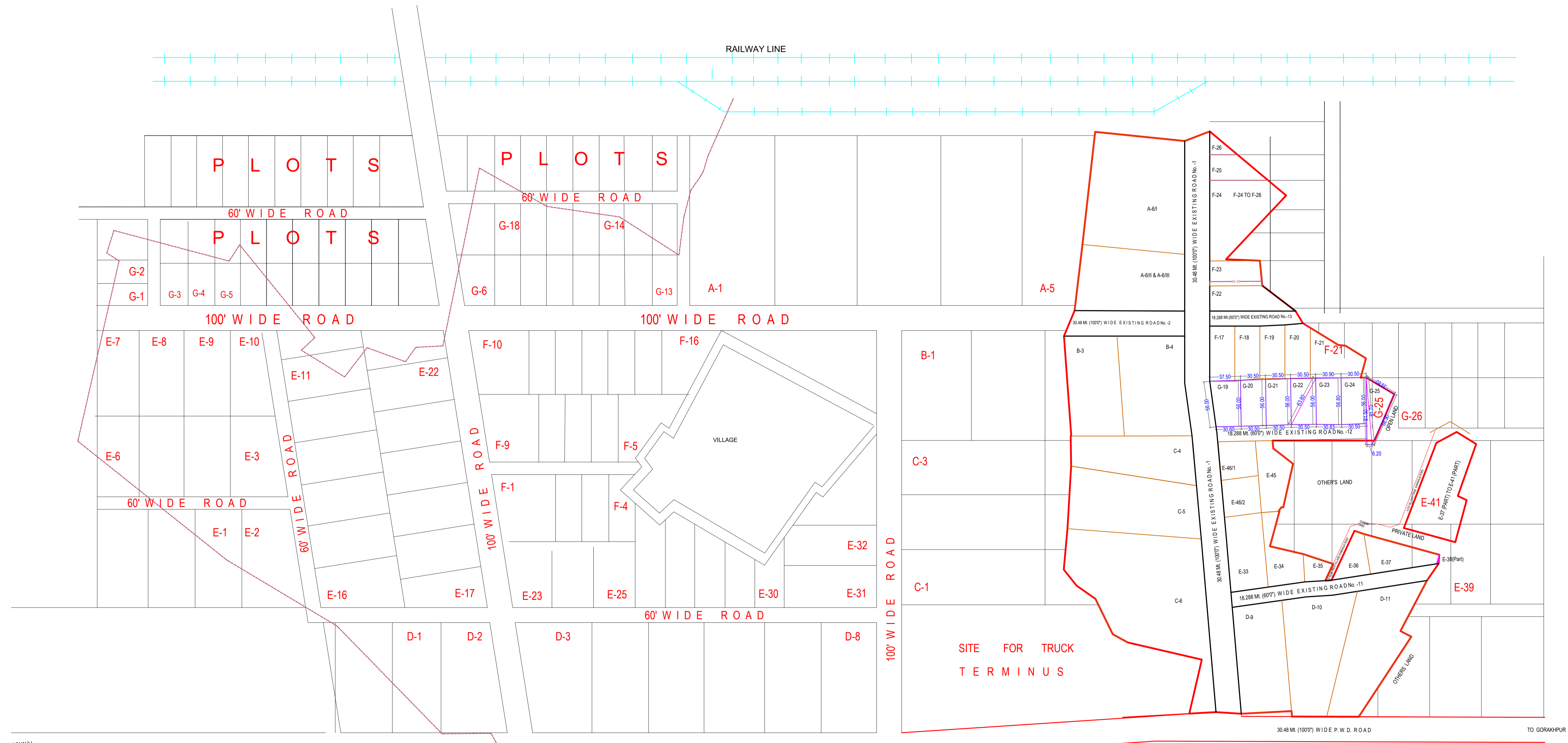

BULK LAND

TOTAL LAND AREA 20.82 HECT

TOTAL LAND AREA AS PER  
 SURVEY PLAN = 2703945.80Sq.Mt. (668.15 Acres)  
 LAND UNDER NALA = 27054.74 Sq.Mt. ( 6.68 Acres)  
 NET AREA FOR  
 DEVELOPMENT = 2676891.06 Sq.Mt.( 661.46 Acres)

### DISTRIBUTION OF AREA

Sl. No.	TYPE	USE	AREA IN ACRES
1.	A	I.O.C. (ALLOTTED)	10.51
2.	BL-1	C.R.P.F (ALLOTTED)	264.73
3.	BL-2	BULK LAND	100.00
4.	BL-3	BULK LAND	41.28
5.	BL-4	BULK LAND	39.99
6.	BL-5	BULK LAND	120.74
7.	BL-6	BULK LAND	52.28
8.	F-1	FACILITIES	14.81
9.	P-1	PARK	03.80
10.		AREA UNDER ROAD	13.32
TOTAL			661.46

**NOTE:**  
 1. THIS LAY-OUT PLAN HAS BEEN PREPARED AS PER LAY-OUT PLAN PROVIDED BY EX. ENGR. C.D.-6 & R.M. FAIZABAD VIDE LETTER NO.2091 DT.01-01-2019  
 2. THE AREA'S OF PLOTS ARE GIVEN IN THIS LAY-OUT PLAN HAS BEEN PROVIDED BY R.M. FAIZABAD VIDE LETTER NO.2091 DT.01-01-2019

**DISCLAIMER:-**  
 THIS MAP IS PROVIDED FOR INFORMATION PURPOSE ONLY AND IS NOT INTENDED FOR USE IN LEGAL PROCEEDINGS. THE ACCURACY AND COMPLETENESS OF THE INFORMATION REPRESENTED ARE NOT GUARANTEED. THE INFORMATION PRESENTED HEREIN INCLUDING BOUNDARIES, LAND USE DESIGNATIONS, AND OTHER DETAILS, IS SUBJECT TO CHANGE WITHOUT PRIOR NOTICE. THE MAP SHOULD NOT BE USED AS A LEGAL DOCUMENT OR FOR ANY PURPOSE REQUIRING PRECISE MEASUREMENTS OR LEGAL VALIDATION. FOR OFFICIAL AND LEGALLY BINDING INFORMATION PLEASE CONSULT RELEVANT OFFICE AUTHORITY.

**ARCHITECTURAL CELL**



UPSIDA COMPLEX  
 A-1/4 LAKHANPUR KANPUR.

**JOB TITLE:**  
 EXISTING LAY-OUT PLAN OF INDUSTRIAL AREA GORAKHPUR

sd.dt. 29-01-2013

KANCHAN HANSPAL  
 Asst.MANAGER ( Arch.)

HIMANSHU MISHRA  
 INCHARGE ( A.T.P.)

PROMOD KUMAR PANDEY  
 JLMANAGING DIRECTOR

RAJESH KUMAR SINGH  
 MANAGING DIRECTOR

Scale : 1:4000  
 DATE :10-01-2019

Draw. No. : upsida/stp/gorakhpur/

Drawn By: U.S.YADAV ( D/Mar)