

**LAYOUT PLAN OF PLAN OF INDUSTRIAL AREA SIKANDRABAD (GOPAL PUR) DISTT. BULANDSHAHAR
(FOR REFERENCE ONLY)**

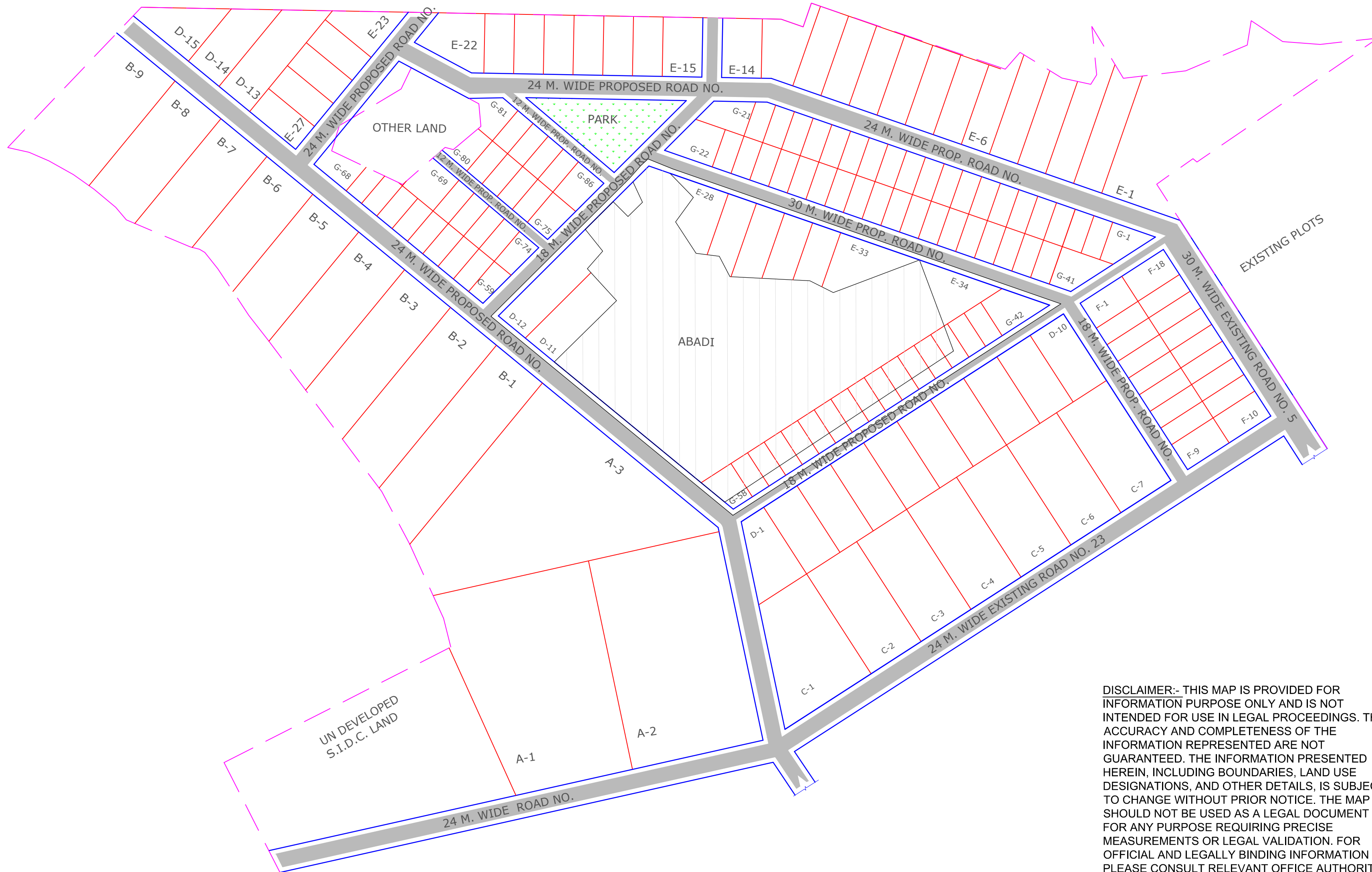

LAND USE ANALYSIS

S.NO.	USE	AREA IN HECTS	%OF TOTAL
1.	PLOTS	48.948	83.24
2.	PARK	0.614	1.05
3.	ROAD	9.237	15.71
TOTAL		58.80	100.00

STATEMENT OF PLOTS.

S.NO.	TYPE	SIZE IN .MT	AREA IN SQ.M	NOS.
1.	A-1	TO SIZE	30240	01
2.	A-2	TO SIZE	29376	01
3.	A-3	TO SIZE	33392	01
4.	B-1 TO B-9	TO SIZE	11760 TO 7200	09
5.	C	60 X 120	7200	07
6.	D-1 TO D-10	40 X 80	3200	10
7.	D-11 TO D-15	TO SIZE	3600 TO 4800	05
8.	E-1 TO E-14	TO SIZE	2700 TO 17700	14
9.	E-15 TO E-27	30 X 60	1800.00	13
10.	E-28 TO E-34	TO SIZE	1800 TO 2400	07
11.	F	20 X 50	1000.00	18
12.	G	20 X 40	800.00	86
TOTAL				172

BOUNDARY LINE ---
 VILLAGE BOUNDARY LINE ---

ARCHITECTURAL CELL



UPSIDC COMPLEX
A 1/4 LAKHANPUR , KANPUR.

JOB TITLE- INDUSTRIAL AREA SIKANDRABAD SUB.DIVISION GOPALPUR	R.K. SRIVASTAVA DY.MANAGER (ARCH) BHUPESH SINGH MANAGER (A.T.P) SAT PERKASH DY.GENERAL MANAGER CHIEF MANAGER (ATP)
DRG.TITLE- LAYOUT PLAN	S.N SHUKLA GENERAL MANAGER
REVISION NO.	N.S NADALCHYAL MANAGER DIRECTOR
SCALE: 1CM=20M	DATE - 17-08-88
DRG. NO, SIDC/DY G.M. (I.M)/ARCH	
DRAWN BY- S.D TRIPATHI D/MAN	

DISCLAIMER:- THIS MAP IS PROVIDED FOR INFORMATION PURPOSE ONLY AND IS NOT INTENDED FOR USE IN LEGAL PROCEEDINGS. THE ACCURACY AND COMPLETENESS OF THE INFORMATION REPRESENTED ARE NOT GUARANTEED. THE INFORMATION PRESENTED HEREIN, INCLUDING BOUNDARIES, LAND USE DESIGNATIONS, AND OTHER DETAILS, IS SUBJECT TO CHANGE WITHOUT PRIOR NOTICE. THE MAP SHOULD NOT BE USED AS A LEGAL DOCUMENT OR FOR ANY PURPOSE REQUIRING PRECISE MEASUREMENTS OR LEGAL VALIDATION. FOR OFFICIAL AND LEGALLY BINDING INFORMATION PLEASE CONSULT RELEVANT OFFICE AUTHORITY.