

**LAYOUT PLAN OF SECTOR -3 TDS CITY GHAZIABAD
(FOR REFERENCE ONLY)**

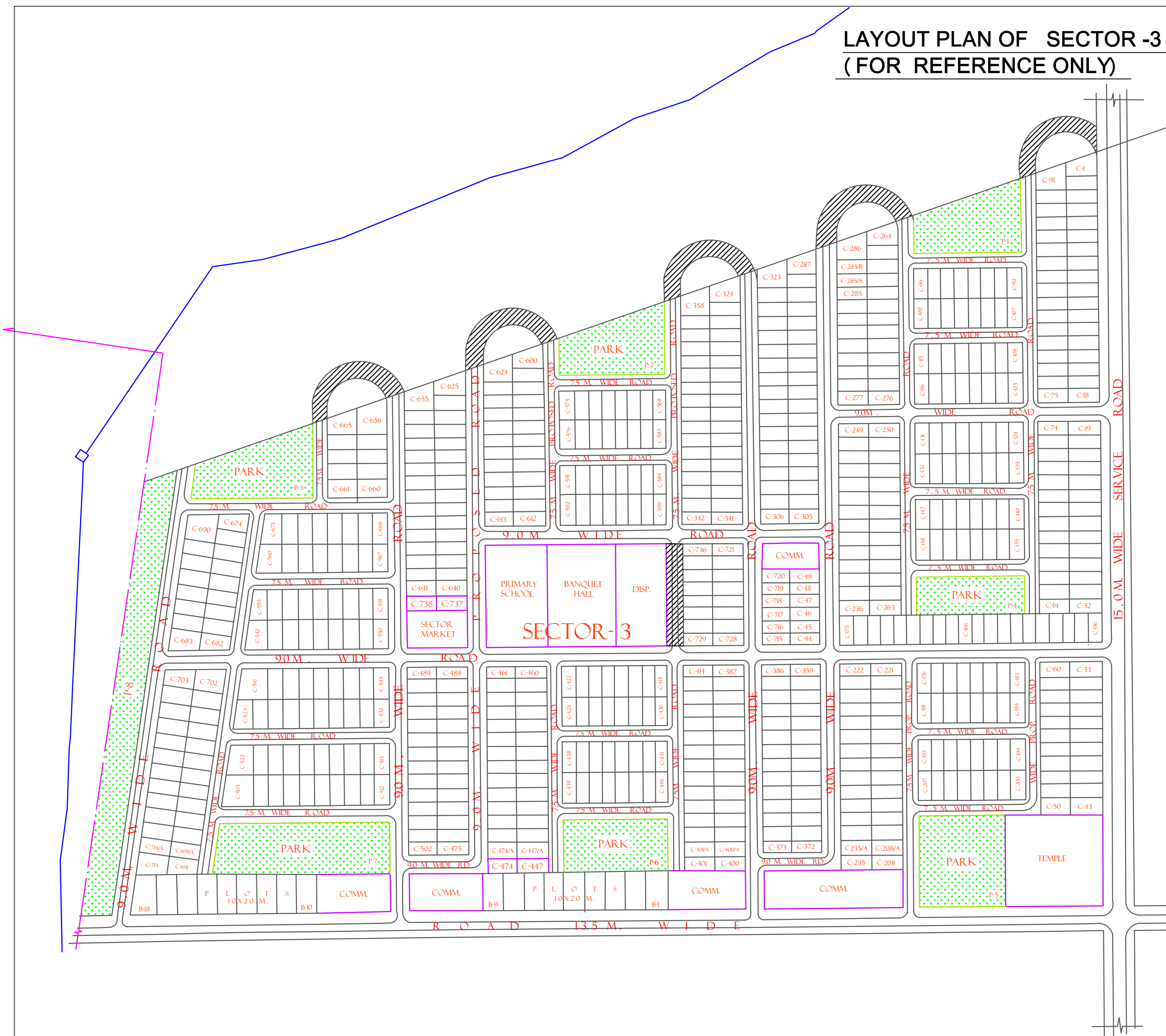

LAND USE ANALYSIS

SNO.	USED	AREA IN HECT.	% OF TOTAL
1.	PLOTS	8.356	44.93
2.	C.F.C.	0.752	4.14
3.	PRIMARY SCHOOL	0.240	1.31
4.	TEMPLE	0.225	1.23
5.	DISPENSARY	0.180	0.99
6.	COMMERCIAL	0.857	4.71
7.	PARKS	2.359	12.97
8.	ROADS	5.410	29.72
	TOTAL	18.20	100.00

STATEMENT OF PLOTS

SNO.	TYPE	SIZE IN MT.	AREA IN MT.SQ.	TOTAL NOS.	REMARK
1.	B	10X20	200.00	18	—
2.	C	6.66X15.0	100.00	738	—
			TOTAL	756	

DISCLAIMER:- THIS MAP IS PROVIDED FOR INFORMATION PURPOSE ONLY AND IS NOT INTENDED FOR USE IN LEGAL PROCEEDINGS. THE ACCURACY AND COMPLETENESS OF THE INFORMATION REPRESENTED ARE NOT GUARANTEED. THE INFORMATION PRESENTED HEREIN, INCLUDING BOUNDARIES, LAND USE DESIGNATIONS, AND OTHER DETAILS, IS SUBJECT TO CHANGE WITHOUT PRIOR NOTICE. THE MAP SHOULD NOT BE USED AS A LEGAL DOCUMENT OR FOR ANY PURPOSE REQUIRING PRECISE MEASUREMENTS OR LEGAL VALIDATION. FOR OFFICIAL AND LEGALLY BINDING INFORMATION PLEASE CONSULT RELEVANT OFFICE AUTHORITY.

DATE : 29-10-2002

KANCHAN HANSPAL ASST. MANAGER (ARCH)	BHUPESH SINGH MANAGER (A.T.P.)	MKS. SUNDARAM JT. MANAGING DIRECTOR
AIJAZ HUSAIN DY. MANAGER (ARCH)	Y.P. SINGH GENERAL MANAGER (D)	RAJIV KUMAR MANAGING DIRECTOR

ARCHITECTURAL CELL



UPSIDA COMPLEX
A/14 LAKHANPUR, KANPUR.

JOB TITLE: LAYOUT PLAN OF I.A. LONI GHAZIABAD. (SECTOR NO:-3)	BHUPESH SINGH MANAGER (A.T.P.)
	Y.P. SINGH GENERAL MANAGER (D)
	NIVEDITA SHUKLA VERMA JT. MANAGING DIRECTOR

NOTE :-
ROAD TO BE CONSTRUCTED SHOWN THUS

REVISION NO. : 3	DATE : 03-05-99
BHUPESH SINGH MANAGER (A.T.P.)	Y.P. SINGH GENERAL MANAGER (D)
ARUN SINGHAL JT. MANAGING DIRECTOR	RAJIV KUMAR MANAGING DIRECTOR

SCALE : 1:1000	DATE : 26-08-98
DRG. NO. SIDC/ATP/KASHMIRI ENCLAVE/99	

DRAWN BY : A.C. MISHRA , D/MAN